

RITCHEY KITE dropper seatpost Installation and User Manual

Important information about use, care, maintenance and mounting

Introduction 1
 Before your first ride – Determined use 2
 Cleaning and Care 3
 Maintenance 3
 General notes on installation 3
 Ritchey Liquid Torque 4
 Using the Ritchey torque wrench 4
 Compatibility of the RITCHEY KITE dropper seatpost 5
 Diameter of the RITCHEY KITE dropper seatpost 5
 Length of the RITCHEY KITE dropper seatpost 5
 Installing the RITCHEY KITE dropper seatpost 6
 Cable routing of the remote control 6
 Preliminary installation of the RITCHEY KITE dropper seatpost 6
 Cutting the remote control cable housing to length 7
 Adjusting the remote control housing the saddle 7
 Installing the saddle 8
 Fore-aft position and tilt of saddle 8
 Adjusting saddle position and tilt 8
 Determining the correct saddle height 9
 Adjusting the correct saddle height 10
 Ritchey KITE dropper seatpost in aluminum, steel or titanium frames 10
 Ritchey KITE dropper seatpost in carbon frames 10
 How to use quick-releases at seatpost clamps 11
 How to securely fasten the seatpost clamp 11
 Installing a saddle bag 12
 Riding with the RITCHEY KITE dropper seatpost 12
 Warranty terms 13
 A note on wear 13
 Maintenance and service 14
 Tools required 14
 Disassembling the RITCHEY KITE dropper seatpost 14
 Assembling the RITCHEY KITE dropper seatpost 15
 Manufacturer's guarantee 16

Notes on this user manual
 Pay particular attention to the following symbols:

! This symbol means that your life or health may be in danger unless you comply with provided instructions or carry out prescribed measures.

A This symbol warns you about actions that could lead to damage of property or the environment.

A This symbol indicates there is special information on how to handle the product and may refer you to a specific passage in this manual requiring your special attention.

The possible consequences described above are not repeated every time one of the symbols appears!

Introduction
 Congratulations on your purchase of a RITCHEY component, you have made an excellent choice. At Ritchey We develop, test and manufacture our products with dedication and strive to uphold the highest possible standards of quality. Like all high quality sports equipment, RITCHEY components require careful installation in order to function properly and provide long-term durability. We recommend that you seek the assistance of a qualified mechanic at your local authorized RITCHEY retail shop. We also recommend using all RITCHEY components to ensure optimal performance and durability. Our precise tolerances are intended to ensure component compatibility and are carefully monitored during production and quality control so that installation will be easy and trouble-free.

A note on wear
 This manual contains important notes about use, care, maintenance and installation.



Adjusting saddle position and tilt

The RITCHEY KITE dropper seatpost design consists of a two-bolt clamping assembly adjusting the tilt and the vertical position of the saddle.
 Release both bolts at the RITCHEY KITE dropper seatpost head. Unscrew the bolts by two to three turns at most, otherwise the whole mechanism will fall apart.
 Move the saddle forward or backward by sliding its rails in the loosened seatpost clamp. To adjust tilt, put one hand on the front of the saddle and one on the back (21) and carefully rotate the saddle in either direction. You may need to give the saddle a light tap initially to get it to move in the assembly.

Determining the correct saddle height
 Correct saddle height provides maximum pedaling comfort and efficiency. When pedaling, the pedal axles (or "spindles") should be positioned directly below or slightly behind the ball of your foot.
 With the pedal axles positioned under your feet as described above, your legs should not extend completely at the pedal's farthest point from the saddle during your pedal stroke (23), otherwise your motions will become awkward and you may stress your knees and other joints. You can check the height of your saddle in the following simple way. This is best done by wearing flat-soled casual shoes.
 Sit on the saddle (24) with your hips even and put your heel on the pedal at the pedal's most distant rotational point from the saddle. In this position your leg should be fully stretched and your hips should not be tilted to either side.

Determining the correct saddle height
 To modify the saddle height, loosen the seat clamp binder or the quick-release (read section "How to use quick-releases at seatpost clamps") before. Use a suitable tool to loosen the seat clamp binder bolt, turning it counterclockwise two to three turns, or open the seat clamp binder. Now the loosened RITCHEY KITE dropper seatpost can be adjusted in height.
 Do not pull the RITCHEY KITE dropper seatpost too far out of the seat tube. The "hash" marks or numbered position lines (MIN) (35) on the back of the RITCHEY KITE dropper seatpost serve as a reference.
 In the case of frames with seat tubes that extend beyond the top of the frame's top tube, the RITCHEY KITE dropper seatpost should be inserted into the seat tube at least a few millimeters below the bottom of the top tube and below the rear stays. This can mean a minimum insertion depth of 10 centimeters (4.5 in.) and more.

Determining the correct saddle height
 When riding off-road it can be helpful to lower the RITCHEY KITE dropper seatpost slightly. However, be aware that a lower seatpost position over extended periods can lead to knee pain if you experience knee or hip discomfort, immediately seek the advice and assistance of a certified bicycle fit expert or RITCHEY retailer.
 When riding off-road it can be helpful to lower the RITCHEY KITE dropper seatpost slightly. However, be aware that a lower seatpost position over extended periods can lead to knee pain if you experience knee or hip discomfort, immediately seek the advice and assistance of a certified bicycle fit expert or RITCHEY retailer.

Adjusting the correct saddle height
 To modify the saddle height, loosen the seat clamp binder or the quick-release (read section "How to use quick-releases at seatpost clamps") before. Use a suitable tool to loosen the seat clamp binder bolt, turning it counterclockwise two to three turns, or open the seat clamp binder. Now the loosened RITCHEY KITE dropper seatpost can be adjusted in height.
 Do not pull the RITCHEY KITE dropper seatpost too far out of the seat tube. The "hash" marks or numbered position lines (MIN) (35) on the back of the RITCHEY KITE dropper seatpost serve as a reference.
 In the case of frames with seat tubes that extend beyond the top of the frame's top tube, the RITCHEY KITE dropper seatpost should be inserted into the seat tube at least a few millimeters below the bottom of the top tube and below the rear stays. This can mean a minimum insertion depth of 10 centimeters (4.5 in.) and more.

Adjusting the correct saddle height
 To modify the saddle height, loosen the seat clamp binder or the quick-release (read section "How to use quick-releases at seatpost clamps") before. Use a suitable tool to loosen the seat clamp binder bolt, turning it counterclockwise two to three turns, or open the seat clamp binder. Now the loosened RITCHEY KITE dropper seatpost can be adjusted in height.
 Do not pull the RITCHEY KITE dropper seatpost too far out of the seat tube. The "hash" marks or numbered position lines (MIN) (35) on the back of the RITCHEY KITE dropper seatpost serve as a reference.
 In the case of frames with seat tubes that extend beyond the top of the frame's top tube, the RITCHEY KITE dropper seatpost should be inserted into the seat tube at least a few millimeters below the bottom of the top tube and below the rear stays. This can mean a minimum insertion depth of 10 centimeters (4.5 in.) and more.

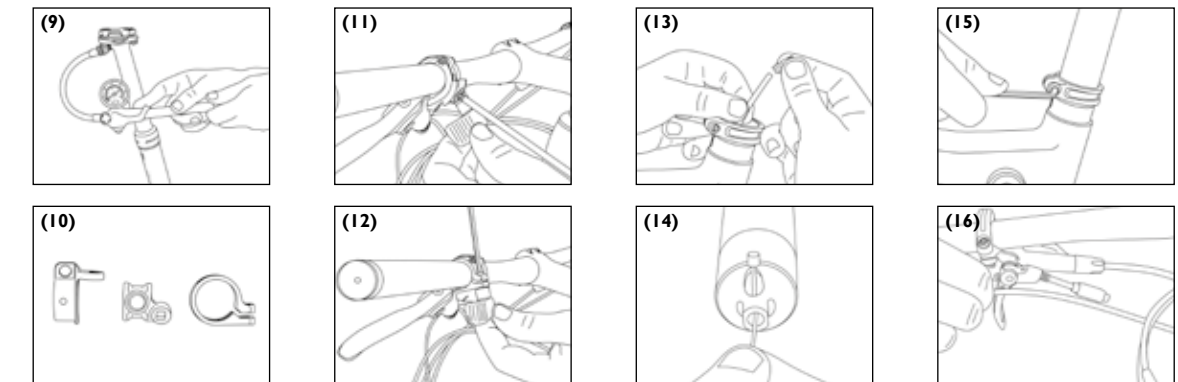
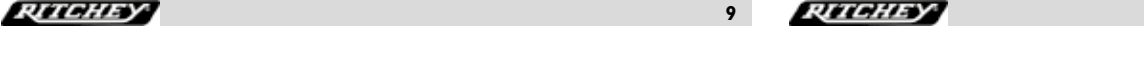

Before your first ride – Determined use

The RITCHEY KITE dropper seatpost is designed to use on mountain bikes and their typical use.
 It is, however, not built for freeriding, dual slalom, downhill, dirt jumps and comparable uses.
 Never make any changes to the RITCHEY KITE dropper seatpost or the saddle. Do not tie or drill any holes in the components. This applies especially to carbon components, as this will compromise their structural integrity and void your warranty.
 We recommend that you always use RITCHEY parts together in order to achieve optimum performance and component durability. If you intend to combine RITCHEY parts with parts from other manufacturers, make sure they are compatible, i.e. that all dimensions are identical with the specifications given in this manual.
 RITCHEY saddles and RITCHEY KITE dropper seatposts are designed to carry a maximum rider's weight of 110 kilos (242 lbs) baggage, e. backpack, included.
 In case you have any questions, please contact your RITCHEY dealer.

Cleaning and care
 Clean your RITCHEY KITE dropper seatpost and your saddle with water and a soft cloth (1+2) at regular intervals. A periodical removal and cleaning of the RITCHEY KITE dropper seatpost will protect it from the effects of electrolytic corrosion. Clean at least the glide surface of the upper seatpost tube of the RITCHEY KITE dropper seatpost after every ride. If necessary, use a non-abrasive soap to remove grime. You may add a little detergent liquid for cleaning and removing tough stains, such as oil or grease. Do not use degreasing agents, which contain organic solvents (e.g. acetone, trichloroethylene, methylene, etc.). Chemicals of this sort may damage the finish or substructure of the material.
 While cleaning, look for cracks, scratches, dents, as well as for bent or discolored material. If you think there may be a problem, see your local RITCHEY dealer. Have damaged or defective components replaced immediately.
 Remove and clean the RITCHEY KITE dropper seatpost periodically to protect it from the effects of electrolytic corrosion.
 After a crash, accident or other major impact, have your saddle and RITCHEY KITE dropper seatpost checked by your RITCHEY dealer for your own safety.
 If your RITCHEY KITE dropper seatpost or saddle produces any cracking or cracking noises or shows external damage such as notches, cracks, dents, discoloration etc., do not use your bicycle until you have consulted your RITCHEY dealer who can check the parts carefully and advise whether replacement is necessary.
 The bolts of the RITCHEY KITE dropper seatpost have bolt retaining compound on the threads. Do not grease the threads for this reason!



General notes on installation

The installation of the RITCHEY KITE dropper seatpost and the saddle, in general, are jobs for a qualified mechanic. Have this work done by an authorized RITCHEY dealer only. Each of the following instructions must be followed strictly. Non-observance of these instructions can lead to component failure, resulting in a severe accident or injuries.
 Installing non-matching parts can result in clamping failure and consequently in a serious accident.
 We recommend using a RITCHEY torque wrench with a RITCHEY saddle an vice versa, because they are designed to fit and function as an integrated whole. If you choose to use a part from another manufacturer, read the respective manual regarding clamping diameter to ensure proper fit and compatibility with RITCHEY components.
 RITCHEY assumes no responsibility for problems resulting from a RITCHEY component being used with a part from another manufacturer.
 Before installation watch out for sharp edges and burrs in the seat tube of the frame (4), at the seatpost clamp and the saddle clamping. Do not use these components, if they have burrs or sharp edges. If there are burrs or sharp edges on a RITCHEY or non-RITCHEY component, have your local RITCHEY dealer inspect it. They will see, whether this is a problem that can be solved or whether the component has to be replaced.
 Once it is determined that a component is damaged, it should not be used under any circumstances. Stop using the bike until the part has been replaced. If there is any doubt, we recommend replacing the part.
 The bolts of the RITCHEY KITE dropper seatpost have bolt retaining compound on the threads. Do not grease the threads for this reason!

Maintenance
 Check the torque values of all bolts (3) after the first 200 to 400 km (120 to 240 miles). Tighten them, if necessary, using a torque wrench to the prescribed torque setting. Check every 2,000 kilometers (1,242 miles) thereafter.
 Tightening the bolts or closing the quick-release should not require too much strength or force. If it does, it may be that the RITCHEY KITE dropper seatpost does not match the frame. Check the tight fit of the RITCHEY KITE dropper seatpost. Take hold of the saddle at both ends to try to rotate the seatpost inside the seat tube. If the seatpost does rotate, you have to re-tighten the clamp bolt or the quick-release in small increments and check again. Make sure not to exceed the specified torque values.
 If the RITCHEY KITE dropper seatpost can still be moved, check whether the bolt was tightened to the specified torque value. If you are not sure in this point, read the manufacturer's user manual or ask your RITCHEY dealer for help. If the recommended torque (5 Nm) was applied to the bolts and the clamping force is still not sufficient, ask your RITCHEY dealer for help. Ask your RITCHEY Liquid Torque to the clamping surfaces. Tighten the bolt again to the recommended torque value. If the RITCHEY KITE dropper seatpost is still not tight, contact your RITCHEY dealer or ask a skilled mechanic for advice.
 Do not apply grease to the seat tube of a RITCHEY KITE dropper seatpost. Grease and other components may never again provide a safe clamping surface!
 Do not over-tighten the clamping mechanism of the seat tube. Over-tightening can result in damage to the RITCHEY KITE dropper seatpost or frame and lead to an accident with injuries of the rider.



RITCHEY Liquid Torque

Carbon fiber frames and components are particularly vulnerable to damage caused by excessive clamping force. RITCHEY Liquid Torque (5) creates extra friction between two surfaces, allowing the necessary clamping force to be reduced by up to 30%.
 In addition, it prevents frequent cracking noises in the clamping areas. It also retains its effectiveness in wet conditions and provides maximum protection against corrosion.
 RITCHEY Liquid Torque can be used for all carbon, aluminum and steel connections including:
 • seatpost/frame clamping areas and the threads of the seatpost clamping bolts
 • stem/handlebars clamping areas and clamping bolts
 • stem/fork, clamping areas and crank bolts
 • bolt threads in any area where reliable clamping force is required, but where loosening with the appropriate tool should be easy, even after prolonged use. RITCHEY Liquid Torque is ideally suited because it does not harden.
 Directions for use: Before applying RITCHEY Liquid Torque, remove dirt, particles and lubricant residues from the surfaces to be treated. Next, apply a thin and even coat of RITCHEY Liquid Torque to the cleaned surfaces using a brush, lint-free textile or chamois/artificial chamois. Install components as directed by the manufacturer using a torque wrench and make sure not to exceed the manufacturer's maximum torque recommendations. After tightening to specified torque, wipe off any excess Liquid Torque.
 Re-seal RITCHEY Liquid Torque container after use.

Using the RITCHEY torque wrench
 To achieve a reliable clamping of two parts, RITCHEY considers the use of a torque wrench (3) absolutely necessary.
 If the maximum torque given by RITCHEY does not generate sufficient clamping force, apply RITCHEY Liquid Torque to interconnecting surfaces to increase friction.
 Exceeding recommended torque (generally indicated somewhere on the part to be clamped) will create too much clamping force, running the risk of component failure. This not only bears a high risk of accident, but also voids the warranty.
 Loose or overly tight bolts can result in component failure and in an accident. Strictly observe the torque specifications. If you do not have a high-quality torque wrench, see your local RITCHEY dealer.



Compatibility of the RITCHEY KITE dropper seatpost

The lowering of the RITCHEY KITE dropper seatpost is operated via cable remote control through the frame. Make sure your bicycle frame is designed for this cable routing. If you are not sure whether the RITCHEY KITE dropper seatpost is compatible with your frame, contact your local RITCHEY dealer or the bicycle manufacturer.
 Do not drill any holes into your frame and do not make any other changes on your frame. This will render void the warranty of the RITCHEY KITE dropper seatpost as well as the warranty of your frame or even of the entire bicycle. Any change to your frame or another bicycle part may lead to breakage or other kind of failure resulting in serious injuries and even death.
 The separate handlebar clamp can be installed on the left or right of the brake and shift levers on the left handlebar. The remote control lever is inserted in the desired position into the square hole of the clamp. Tighten the clamping only so far (12) that you have to apply high forces to rotate the remote control on the handlebars.

Length of the RITCHEY KITE dropper seatpost
 Check with the fully extended RITCHEY KITE dropper seatpost that it is long enough or not too long in consideration of the minimum insertion depth and that you are able to see the saddle to the desired height. To do so extend the RITCHEY KITE dropper seatpost to its full length and hold it in parallel to the seatpost used so far. Keep in mind that when using another saddle this suitable height may be different.
 The RITCHEY KITE dropper seatpost is delivered ex works in compressed position and without air pressure. Insert a suitable tool (e.g. screw-driver) through the opening on the side of the cover cap at the lower seatpost tube and lever the counter bearing of the cable downwards; now you can extend the seatpost to its full length. Remove the protection cap from the air valve in the top area of the seatpost. Tighten the clamping only so far (12) that you have to apply high forces to rotate the remote control on the handlebars.
 Make sure the diameter of your new RITCHEY KITE dropper seatpost matches the seat tube of your frame. Measure the RITCHEY KITE dropper seatpost and the seat tube (6+7). The difference between the (bigger) inner diameter of the seat tube and the (smaller) outer diameter of the RITCHEY KITE dropper seatpost should be 0.1 mm (0.002 to 0.001 in.). RITCHEY KITE dropper seatposts are available at outer diameters of 30.9 mm and 31.6 mm (1.22 and 1.24 in.). If the inner diameter of the seat tube is bigger, you can use an appropriate adapter sleeve with matching inner and outer diameter as well as an installation length of 80 mm (3.15 in.) at least.
 The two year warranty plan is only valid in countries where European (EU) regulations apply! Please ask your dealer about the regulations in your country.
 Warranty claims will only be accepted if the bicycle has been used for its intended purpose only (see section "Before your first ride - Determined use").
 It does not cover damage resulting from wear (worn seals and piston material), neglect (insufficient care and maintenance), accidents, overstress caused by overloading, incorrect installation, improper treatment or as a result of changes to the components.
 Strictly follow all assembly instructions in this manual as well as all additional instructions provided by the manufacturers of products used in conjunction with RITCHEY products, especially bolt torque specifications and the prescribed maintenance instructions. Observe all user manuals with regard to the behavioral procedures and control procedures that are mentioned in this manual. But also observe any other manuals that may be enclosed with RITCHEY products. Also adhere strictly to any and all instructions pertaining to the replacement of safety relevant components, such as seat posts, etc.
 Your direct contact with regard to all issues outlined in this manual and corresponding instructions is your local RITCHEY dealer, who is qualified to answer your questions. To handle your claim you need to present your receipt.



Installing the RITCHEY KITE dropper seatpost

There are 4 possibilities or options (10) to install the handlebar remote control:
 1. Separate handlebar clamp, lever above the handlebar on the left (if the front derailleur shift lever is mounted under the handlebar on the left)
 2. Separate handlebar clamp, lever under the handlebar on the left and/or on the right handlebar on top
 3. Lever with adapter on the Sram brake lever under the handlebar on the left
 4. Lever with adapter on the Shimano I-spec II brake lever under the handlebar on the left.
 The RITCHEY KITE dropper seatpost will be provided with a standard clamp-style remote for use with bikes without shift lever on the left. Adapters for Sram brake mounts, Shimano I-spec II or above bar mount are available as separate parts.
 In case of the adapter installation to Sram or Shimano brake levers, follow the user manuals of the respective components to install the suitable adapter. In this case the remote control lever (11) is inserted in the desired position into the square hole of the adapter and fastened with the supplied hex bolts (torque value: 3-4 Nm).
 The separate handlebar clamp can be installed on the left or right of the brake and shift levers on the left handlebar. The remote control lever is inserted in the desired position into the square hole of the clamp. Tighten the clamping only so far (12) that you have to apply high forces to rotate the remote control on the handlebars.
 The RITCHEY KITE dropper seatpost must fit snugly into the frame, without the need to push or twist. On the other side, there should be no play and the seatpost should not move when inserted.
 Simultaneously, pull the remote control cable housing back to the handlebars to avoid its bending in the seat tube. Also avoid a routing which leads to an increased friction of the cable.
 Tighten the clamp bolt (15) or close the quick-release (read section "How to use quick-releases at seatpost clamps") before only so far that the RITCHEY KITE dropper seatpost no longer slides, when installing the saddle, as described in the following.

Observing the specifications of the frame or bicycle manufacturer
 Observe the specifications of the frame or bicycle manufacturer as regards the minimum insertion depth (8).
 Varying dimensions of frame and RITCHEY KITE dropper seatpost may result in failure of the RITCHEY KITE dropper seatpost and thus in a crash and potential injury to the rider.
 For detailed information about the RITCHEY online shop, visit the online shop of RITCHEY International. Contact shop at: www.ritcheylogic.com.
 Observe the specifications of the frame or bicycle manufacturer as regards the minimum insertion depth (8).
 Varying dimensions of frame and RITCHEY KITE dropper seatpost may result in failure of the RITCHEY KITE dropper seatpost and thus in a crash and potential injury to the rider.



Installing the handlebar remote control

There are 4 possibilities or options (10) to install the handlebar remote control:
 1. Separate handlebar clamp, lever above the handlebar on the left (if the front derailleur shift lever is mounted under the handlebar on the left)
 2. Separate handlebar clamp, lever under the handlebar on the left and/or on the right handlebar on top
 3. Lever with adapter on the Sram brake lever under the handlebar on the left
 4. Lever with adapter on the Shimano I-spec II brake lever under the handlebar on the left.
 The RITCHEY KITE dropper seatpost will be provided with a standard clamp-style remote for use with bikes without shift lever on the left. Adapters for Sram brake mounts, Shimano I-spec II or above bar mount are available as separate parts.
 In case of the adapter installation to Sram or Shimano brake levers, follow the user manuals of the respective components to install the suitable adapter. In this case the remote control lever (11) is inserted in the desired position into the square hole of the adapter and fastened with the supplied hex bolts (torque value: 3-4 Nm).
 The separate handlebar clamp can be installed on the left or right of the brake and shift levers on the left handlebar. The remote control lever is inserted in the desired position into the square hole of the clamp. Tighten the clamping only so far (12) that you have to apply high forces to rotate the remote control on the handlebars.
 The RITCHEY KITE dropper seatpost must fit snugly into the frame, without the need to push or twist. On the other side, there should be no play and the seatpost should not move when inserted.
 Simultaneously, pull the remote control cable housing back to the handlebars to avoid its bending in the seat tube. Also avoid a routing which leads to an increased friction of the cable.
 Tighten the clamp bolt (15) or close the quick-release (read section "How to use quick-releases at seatpost clamps") before only so far that the RITCHEY KITE dropper seatpost no longer slides, when installing the saddle, as described in the following.

Cable routing of the remote control
 Slide the not yet cut cable housing from the front (handlebars) to the rear (into the seat tube) by following the specifications of the frame or bicycle manufacturer.
 Provide this end of the cable housing with a cable end cap (13) when it protrudes approx. 5 cm (1.97 in.) from the seat tube.
 Insert the end of the cable through the opening on the side of the cover cap at the bottom end of the seatpost and through its cable opening downwards. Hook the cable nipple into the counter bearing of the seatpost (14). Insert the cable completely into the cable housing and slide it into the cable opening on the bottom of the cover cap to the limit stop.
 Preliminary installation of the RITCHEY KITE dropper seatpost
 Provided the diameter is suitable and the components are free of burrs, slide the RITCHEY KITE dropper seatpost slowly into the seat tube to the desired insertion depth for your seating position. Do not insert the RITCHEY KITE dropper seatpost further than necessary into the seat tube to avoid any damage to the visible surface of the seatpost tube.
 The RITCHEY KITE dropper seatpost must fit snugly into the frame, without the need to push or twist. On the other side, there should be no play and the seatpost should not move when inserted.
 Simultaneously, pull the remote control cable housing back to the handlebars to avoid its bending in the seat tube. Also avoid a routing which leads to an increased friction of the cable.
 Tighten the clamp bolt (15) or close the quick-release (read section "How to use quick-releases at seatpost clamps") before only so far that the RITCHEY KITE dropper seatpost no longer slides, when installing the saddle, as described in the following.



Cutting the remote control cable housing to length

Approach the cable housing to the handlebar remote control by ensuring a harmonious, knifedge cable routing with the other cables and brake lines. Make sure the cable is long enough to allow full handlebar movement from one side to the other.
 Cut the cable to length by using the cable cutter and put a ferrule on the cable. Tighten the barrel adjuster (19) so that there is no more play or only minimum play for the cable.
 Calculate the length of the supplied short cable housing as well as of the barrel adjuster and mark the matching length of the cable housing (16) (e.g. with an adhesive tape).
 Remove the RITCHEY KITE dropper seatpost from the seat tube and so far away from the cable housing that the cable is no longer in the position where the cable nipple into the counter bearing of the seatpost (14). Insert the cable completely into the cable housing and slide it into the cable opening on the bottom of the cover cap to the limit stop.
 Preliminary installation of the RITCHEY KITE dropper seatpost
 Provided the diameter is suitable and the components are free of burrs, slide the RITCHEY KITE dropper seatpost slowly into the seat tube to the desired insertion depth for your seating position. Do not insert the RITCHEY KITE dropper seatpost further than necessary into the seat tube to avoid any damage to the visible surface of the seatpost tube.
 The RITCHEY KITE dropper seatpost must fit snugly into the frame, without the need to push or twist. On the other side, there should be no play and the seatpost should not move when inserted.
 Simultaneously, pull the remote control cable housing back to the handlebars to avoid its bending in the seat tube. Also avoid a routing which leads to an increased friction of the cable.
 Tighten the clamp bolt (15) or close the quick-release (read section "How to use quick-releases at seatpost clamps") before only so far that the RITCHEY KITE dropper seatpost no longer slides, when installing the saddle, as described in the following.

Adjusting the remote control
 Before adjusting the remote control the seatpost needs to be extended to normal operating length and pressurized to 0.7 bar (10 psi).
 Operate the remote control lever and make sure there is enough clearance to the shift and brake levers. If there is not, turn the remote control on the handlebars or find another installation position for the remote control.
 Check whether you can lower the RITCHEY KITE dropper seatpost without restrictions. Operate the remote control lever and press the saddle in the lowest position. Release the remote control lever and press it once again – now the saddle should move evenly into the middle or highest position. If it does not, you may have over-tightened the seatpost clamping. Release it a little, if necessary. Until the seatpost lowering function is fully operable. As a next step make sure the seatpost clamping is tight enough and the RITCHEY KITE dropper seatpost cannot be turned anymore.
 Make sure the seatpost is fully locked in one of the three positions when setting up the remote. If not fully locked, the cable tension cannot be adjusted correctly.



Installing the saddle

The RITCHEY KITE dropper seatpost is designed to suit most performance bicycle saddles with round 7 mm (0.28 in.) diameter rails – including many RITCHEY saddles – as well as saddles with slightly ovalized rails (7 mm width x 9 mm height) / (0.28 in. x 0.35 in.).
 To install the saddle unscrew both fixing bolts and remove the upper part of the clamp. Fit the saddle rails in the clamp grooves, re-position the upper part of the clamp (20) and tighten the clamp bolts alternately in small increments until the saddle rail fits snugly between both halves of the clamp. Make sure the top edge of the saddle is in parallel to the ground or the saddle nose points slightly downwards.
 Once there is uniform hold on both rails, tighten the bolts alternately and gradually with a torque wrench (3) until each reaches the maximum torque value, specified on the RITCHEY KITE dropper seatpost in newton meters (10 Nm).
 When riding off-road, especially on a full-suspension bike, your position may vary. That means the nose of the saddle may point slightly upward or downward. For best results and to ensure your comfort and safety, seek assistance from a local RITCHEY dealer.
 Make sure the seatpost clamp assembly is not positioned too close to the bends in the rails at either end of the rails' flat mounting section!
 A saddle's range of adjustment is very small. Replacing the stem allows you to make bigger changes to your position, because stems come in differing lengths. In doing so you may achieve differences of more than ten centimeters (3.94 in.). Changing your stem may require changes in shifter and brake cable lengths – a job best left to your RITCHEY dealer!

Fore-aft position and tilt of saddle
 The inclination of your upper body, and hence your riding comfort and pedaling power, are partially influenced by the distance between the handlebars and the saddle. This distance can be altered by changing the position of the saddle rails in the seatpost clamp. Be aware, however, that this also influences your position relative to the cranks and may affect your pedaling motion. Depending on whether the saddle is positioned more forward or more backward in the seat clamp, your legs will extend further or not as far forward.
 The top of your saddle must be nearly horizontal in order to pedal in a relaxed manner. If it is tilted forward, you will need to apply additional pressure on the handlebars to prevent yourself from slipping forward on the saddle.
 When riding off-road, especially on a full-suspension bike, your position may vary. That means the nose of the saddle may point slightly upward or downward. For best results and to ensure your comfort and safety, seek assistance from a local RITCHEY dealer.
 Make sure the seatpost clamp assembly is not positioned too close to the bends in the rails at either end of the rails' flat mounting section!
 A saddle's range of adjustment is very small. Replacing the stem allows you to make bigger changes to your position, because stems come in differing lengths. In doing so you may achieve differences of more than ten centimeters (3.94 in.). Changing your stem may require changes in shifter and brake cable lengths – a job best left to your RITCHEY dealer!

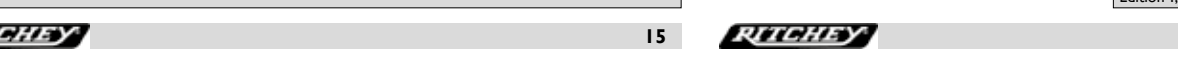

Manufacturer's guarantee

RITCHEY products have been developed and manufactured with great care and have gone through numerous testing controls. Our products are examined as part of our internal quality control process to meet strict standards, as well as by external, neutral test laboratories.
 For the EU market we grant, independent of legal regulation, a voluntary guarantee that your RITCHEY product is free of manufacturing and processing defects for two years from the date of purchase.
 For the North American market we grant, independent of legal regulation, a voluntary guarantee, that your RITCHEY product is free of manufacturing and processing defects for one year from date of purchase.
 The manufacturer's guarantee only applies to claims made by the initial buyer; who must present the purchase receipt with date of purchase, dealer address and model number. Any guarantees are void, if installation instructions are ignored and/or if regular inspection and maintenance requirements are not observed.

Manufacturer's guarantee
 RITCHEY products have been developed and manufactured with great care and have gone through numerous testing controls. Our products are examined as part of our internal quality control process to meet strict standards, as well as by external, neutral test laboratories.
 For the EU market we grant, independent of legal regulation, a voluntary guarantee that your RITCHEY product is free of manufacturing and processing defects for two years from the date of purchase.
 For the North American market we grant, independent of legal regulation, a voluntary guarantee, that your RITCHEY product is free of manufacturing and processing defects for one year from date of purchase.
 The manufacturer's guarantee only applies to claims made by the initial buyer; who must present the purchase receipt with date of purchase, dealer address and model number. Any guarantees are void, if installation instructions are ignored and/or if regular inspection and maintenance requirements are not observed.
 In case of a warranty claim, RITCHEY reserves the right to provide you or part of the current successor model in an available color or if such part is not available, a higher grade model or to remedy the claim. The guarantee does not cover assembly, refitting costs or any new accessories that may be required (e.g. different dimension parts).
 The guarantee does not cover labor and transport costs, nor does it cover follow-up costs resulting from defects.
 Your direct contact for any issue is your RITCHEY dealer, who is authorized to respond to your inquiries.
 In case of any inquiries, please contact your national distributor. Find contact information for your national distributor at: www.ritcheylogic.com



Technical details in the text and illustrations of this manual are subject to change.

© No part of this publication may be reproduced, copied or transmitted by hand or with mechanical or electronic systems or used for an another business purpose without prior written permission.
 Concept and text:
 Zedler – Institut für Fahrradtechnik und -Sicherheit GmbH
 www.zedler.de
 Edition 1, April 2017

