

BREAK-AWAY™ BIKE

SET UP GUIDE



Welcome to the Break-Away™ Club!

Over the last 20 years of seeing the popularity of the Break-Away grow, I've come to see the joy in owning a Break-Away is not only in the liberty of travel, but the empowerment it gives of being one's own mechanic. Of course, for those of you who own a Break-Away, you already know and exemplify this. I sincerely hope you stay happy with your bike and continue to see years of endless miles and travel with it. To ensure this, we are providing you with my personal method for setting up your Break-Away. Please familiarize yourself with it and become an apostle of the Break-Away.

- Tom

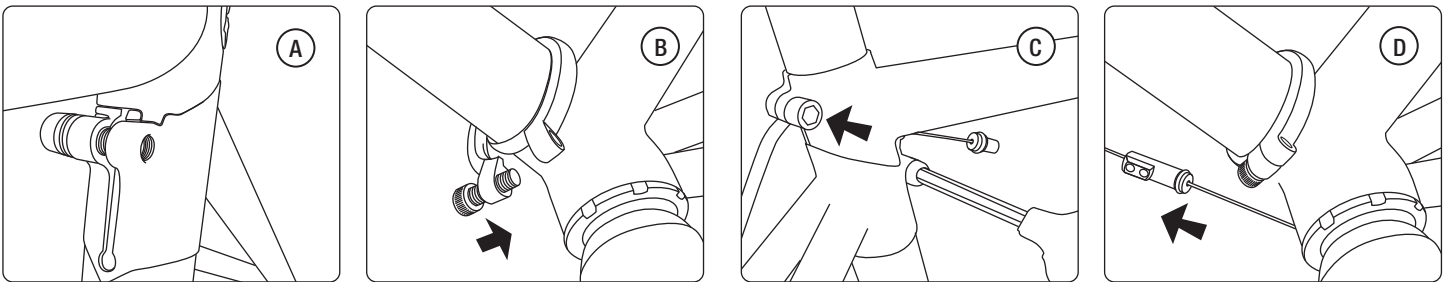

STEP 1:

Lightly grease all threads of both seat tube clamp bolts and down tube clamp bolt and washer first.

If there is resistance in installing fixing bolts in seat tube clamps, either from paint or debris, chase threads with appropriate tap or spare bolt.

NOTE: Make sure clamping area is clean and free of debris. DO NOT LUBRICATE THE CLAMPING AREA OR CLAMP.

STEP 2: (Figure A)

Align frame and insert seat post, make sure seat collar alignment tooth is set in its finger notch (If model is before 2019, disregard notch alignment).

STEP 3: (Figure B)

Align lower frame and loosely install clamp.

STEP 4: (Figure C)

Align front and rear frame sections and insert seatpost keeping bolts loose. Double check top tube and seat tube junction for proper alignment, making sure the seat collar alignment tooth is properly seated in its finger notch and no gap is apparent. Tighten lower seat tube clamp to 5Nm-7Nm; once tooth and notch are in place, secure top tube seat clamp to 5Nm-7Nm.

STEP 5:

Tighten downtube clamp to 4Nm.

NOTE: Never should the lips of the clamp touch each other. Should they do so, a replacement clamp is necessary.

STEP 6: (Figure D)

Connect cable couplers, install wheels and enjoy your ride!

SPECIAL NOTE :

When installing the downtube clamp, be sure the bolt goes through the unthreaded hole and engages the threaded hole.

DO NOT install the bolt into the threaded hole - it will not engage the other side and could lead to a crash and injury.

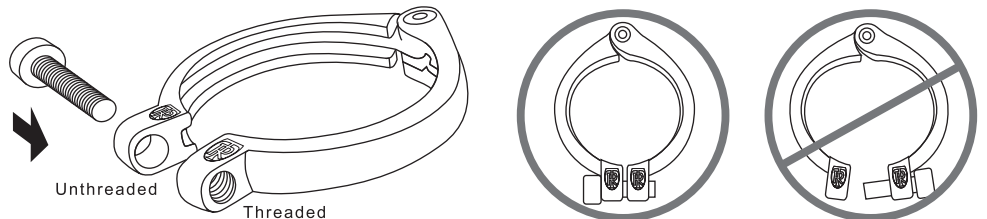

*Note: It's always good practice to check all installed bolts after assembling and riding your Break-Away to make sure all clamps are tightened correctly to proper torque.